

## BSLDE Extended Sintered Bronze Silencer

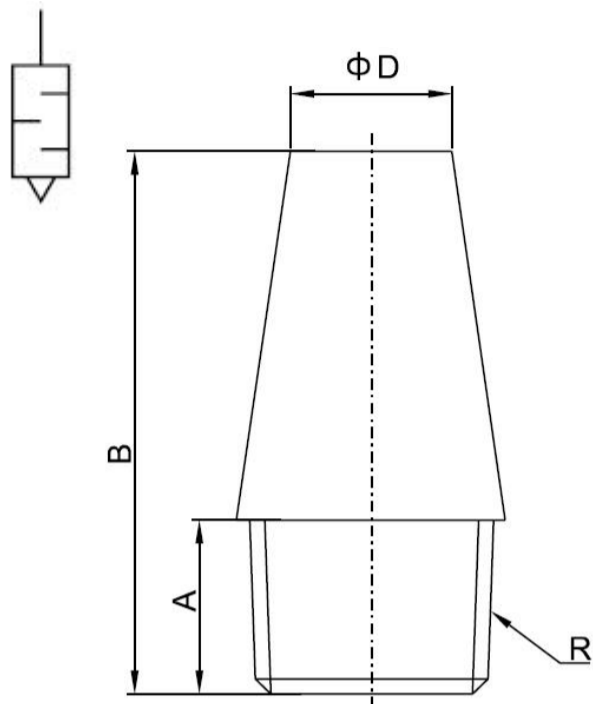

Body(noise absorbing material): Sintered bronze  
Base(thread): Sintered bronze

Working Pressure: 0—1.0MPa | 0—150psi

Proof Pressure: 3.0Mpa | 435psi

Negative Pressure: -100Kpa | -29.5 In Hg

Working Temperature: -25°C~80°C | -13°F~176°F

PART NO.	Sound Pressure Level*	R	B(mm)
BSLDE 01	81	R1/8	60
BSLDE 02	85	R1/4	63
BSLDE G01	81	G1/8	60
BSLDE G02	85	G1/4	63
BSLDE N01	81	1/8NPT	60
BSLDE N02	85	1/4NPT	63

\* Sound pressure level measured at 6 bar at 1 m distance.

\*\* Information contained herein may be changed without prior notification.