

PSE Porous Plastic Muffler

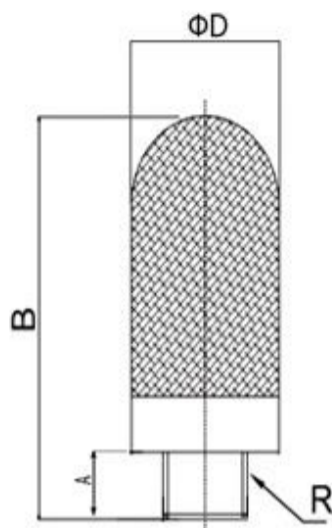

Body(noise absorbing material): Polyethylene
Base(thread): Polyethylene

Working Pressure: 0—1.0MPa | 0—150psi

Proof Pressure: 3.0Mpa | 435psi

Negative Pressure: -100Kpa | -29.5 In Hg

Working Temperature: -10°C~60°C | 14°F~140°F

PART NO.	Sound Pressure Level*	R	A(mm)	B(mm)	D(mm)
PSE M5	-	M5 x 0.8	6	32	7
PSE 01	78	R1/8	7	33	13
PSE 02	80	R1/4	8	41	17
PSE 03	85	R3/8	10	65	25
PSE 04	88	R1/2	13.5	74	25
PSE 06	90	R3/4	15	137	37
PSE 08	95	R1	18	155	48
PSE G01	78	G1/8	7	33	13
PSE G02	80	G1/4	8	41	17
PSE G03	85	G3/8	10	65	25
PSE G04	88	G1/2	13.5	74	25
PSE G06	90	G3/4	15	137	37
PSE G08	95	G1	18	155	48
PSE N01	78	1/8NPT	7	33	13
PSE N02	80	1/4NPT	8	41	17
PSE N03	85	3/8NPT	10	65	25
PSE N04	88	1/2NPT	13.5	74	25
PSE N06	90	3/4NPT	15	137	37
PSE N08	95	1NPT	18	155	48

* Sound pressure level measured at 6 bar at 1 m distance.

** Information contained herein may be changed without prior notification.